



881L 330 kHz Echo Sounder  
445-078 MARCH 2011-REVISED MAY 2017

## IMAGENEX MODEL 881L 330 kHz DIGITAL ECHO SOUNDER

### APPLICATIONS:

- ROV, AUV & UUV
- Offshore Oil & Gas
- Surveying
- Underwater Archaeology
- Scientific Research

### FEATURES:

- Ethernet communications
- Programmable
- High performance
- Low power
- Simple set-up and installation
- 10 to 200 m operation
- Compact size
- Communication format available to user

The Imagenex Model 881L 330 kHz Echo Sounder is a completely self-contained echo sounder with Ethernet communications. It is mounted in a pressure-proof housing with an underwater connector for use in depths up to 1000 meters (~3000 feet). It can be used as a standard echo sounder or with digitized first returns only. Its requirements are minimal, needing only a power source and a digital interface to an external device such as a personal or laptop computer.



Picture shown with optional right angle connector.

<b>HARDWARE SPECIFICATIONS:</b>	
<b>FREQUENCY</b>	330 kHz
<b>TRANSDUCER</b>	Conical
<b>TRANSDUCER BEAM WIDTH</b>	20°(Standard)
<b>RANGE RESOLUTION</b>	10 m & up: 10 mm (0.4")
<b>MIN. DETECTABLE RANGE</b>	1 m (39")
<b>MAX. OPERATING DEPTH</b>	1000 m
<b>MAX. CABLE LENGTH</b>	Standard: 100 m on CAT5e Cable length may be increased up to ~9000 m using an Ethernet extender. Please enquire for more information.
<b>INTERFACE</b>	Standard: 10 Mbps Ethernet (10 BASE-T) using TCP/IP Bit rate may vary if an Ethernet extender is in use.
<b>CONNECTOR</b>	Side mounted, eight conductor, wet mateable (Subconn MCBH8M-AS) Optional right angle or end mount connector
<b>POWER SUPPLY</b>	20 – 32 VDC at less than 3 Watts
<b>DIMENSIONS (for both depth ratings)</b>	79.4 mm (3.125") diameter x 139 mm (5.5") length
<b>WEIGHT: In Air</b>	~1.1 kg (2.3 lbs)
<b>In Water</b>	TBA
<b>MATERIALS</b>	6061-T6 Aluminum & PVC
<b>FINISH</b>	Hard Anodize

<b>SOFTWARE SPECIFICATIONS:</b>	<b>Win881L_ES.exe</b>
<b>WINDOWS™ OPERATING SYSTEM</b>	Windows™ XP, Vista, 7, 8, 10
<b>MODES</b>	Echosounder
<b>RANGE SCALES</b>	10 m, 20 m, 30 m, 40 m, 50 m, 60 m, 80 m, 100 m, 150 m, 200 m
<b>FILE FORMAT</b>	(filename).81L
<b>RECOMMENDED MINIMUM COMPUTER REQUIREMENTS:</b>	100 MHz Pentium 16 MB RAM 1 GB Hard Disk 800 x 600 x 256 colour graphics

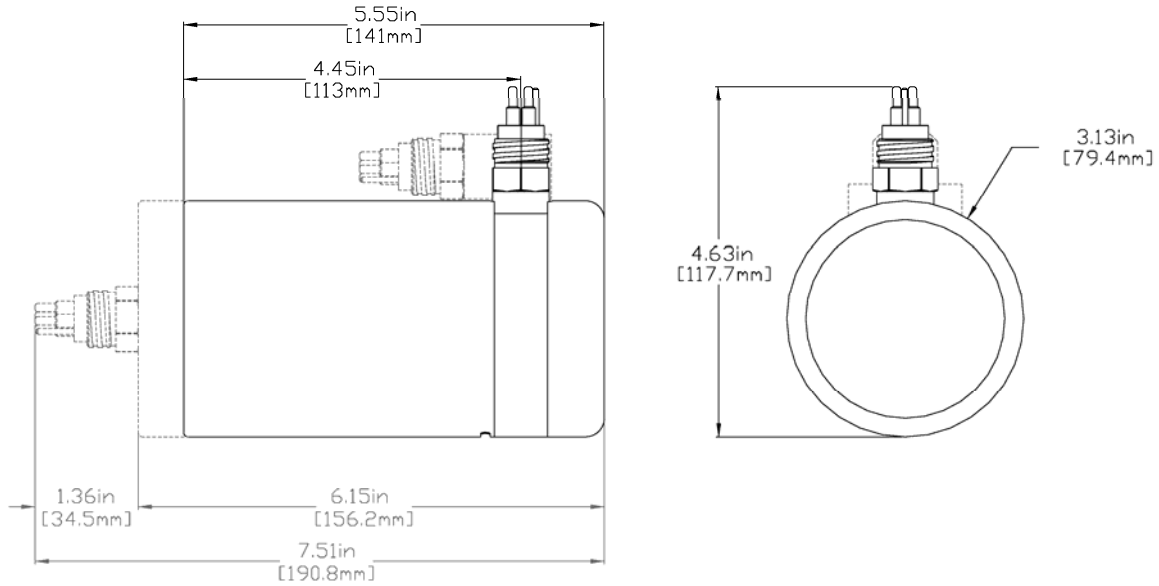

<b>ORDERING INFORMATION:</b>		
<b>1000 m UNIT</b>	Standard	881-000-543
End mount connector	Option	-009
Right angle connector	Option	-010
IP Address*	Option	-020

\*Note: Standard IP Address is 192.168.0.5  
 A different IP Address may be specified upon ordering.

Product and company names listed are trademarks or trade names of their respective companies.

**TAE KWANG ELECTRONICS CORPORATION**  
 5TH FLR., K-BLDG., 3, SANGAM-RO 41-GIL,  
 GANGDONG-GU, SEOUL 05307, KOREA

**T** PHONE : 02 479 2703  
**F** FAX : 02 479 2705  
**E** e-mail : taekwang@tkec.co.kr  
**W** http://www.tkec.co.kr